

SYSTEM TWO

MH Series

THE NEXT STEP IN LIGHTING TECHNOLOGY



- Most efficient surgery lighting source on the market
- Extremely cool output – lowest possible heat
- Superb color temperature
- 10,000 hour rated bulb life
- Wide range mechanical dimming



SYSTEM TWO

MH Series

MH SURGERY LIGHT



- 100,000 lux output at 1 meter
- 4,300° Kelvin color temperature
- 6.5" – 9" adjustable pattern
- 50% – 100% mechanical dimming
- Over 10,000 hour bulb life for primary bulbs

The next level in the evolution of surgery lighting has been achieved with the new **MH** (High Intensity Discharge) **Series**. This all new design heralds a notable increase in efficiency over traditional halogen light sources, producing over 100,000 lux output with only a 39 watt H.I.D. bulb, versus a 150 watt halogen bulb! Heat has been virtually eliminated, while color temperature has been significantly increased to over 4,300° Kelvin. Additionally, the **MH** light boasts a rated bulb life of over 10,000 hours and includes complete mechanical dimming, the most accurate method.



Primary and Secondary Bulbs

Based on the **SYSTEM TWO** mounting platform, the **MH** models are available in a variety of ceiling mountings, wall mount and portable floor models.



Indicator Panel

Quite simply, the **MH Series** signifies a huge step forward in surgery lighting.

M1 MONITOR ARM

Our video monitor arm is a convenient solution for monitor placement.

- Sterile Handle for adjustments within the sterile field
- Provides options for High Definition, fiber optics cabling, video source switching and compatibility with PACS
- Future mountings of dual monitors or monitor/camera will be available
- Can be ordered with or without monitor
- Ceiling mount version as solo arm or shared with lights
- Wall mounted model also available



P1 VIDEO CAMERA

Video Camera capability at a very low price.

- Provides "S-Video" imaging
- 27x optical zoom
- Auto and manual focus
- Sterilizable handle – standard
- Mounted on its own independent arm assembly
- Can be ordered in combination with one or two lights on a Duo or Trio ceiling mounting



Camera Controller

SOLO MOUNT



The *SYSTEMTWO* **MH** Solo offers unparalleled performance and incredible value. Providing advanced high-intensity discharge (H.I.D.) bulb technology, with the articulation and extensive features of the *SYSTEMTWO* product line, the **MH Series** raises the spectrum of surgery lighting to a new level of performance and efficiency.

DUO MOUNT



With the *SYSTEMTWO* **MH** Duo, an uncompromising dual-head surgery light has been created. This model can be configured with two **MH** (H.I.D.) Surgery Lights, one light and Video Camera, or one light and Monitor Arm. All utilize the *SYSTEMTWO* articulating arms system for unlimited flexibility.



TRIO MOUNT



For the ultimate degree of surgery room capability, the *SYSTEMTWO* **MH** Trio has no equal. Unsurpassed value, efficiency and flexibility are the hallmarks of this great new series.

Available with three **MH** (H.I.D.) heads, two Surgery heads with Video Camera, or two Surgery heads with Monitor Arm.

Utilizing the superb articulating arm capabilities of all *SYSTEMTWO* lights, the Trio stands alone in surgery performance.



MH PORTABLE SURGERY LIGHT



The **MH** (H.I.D.) Portable provides all of the fine **SYSTEM TWO MH** features, in a mobile unit of great flexibility, including the ability to fold the head and arm down completely within the footprint of the cantilevered floor base.

Unmatched value in a full-featured portable surgery light!

WALL MOUNTS

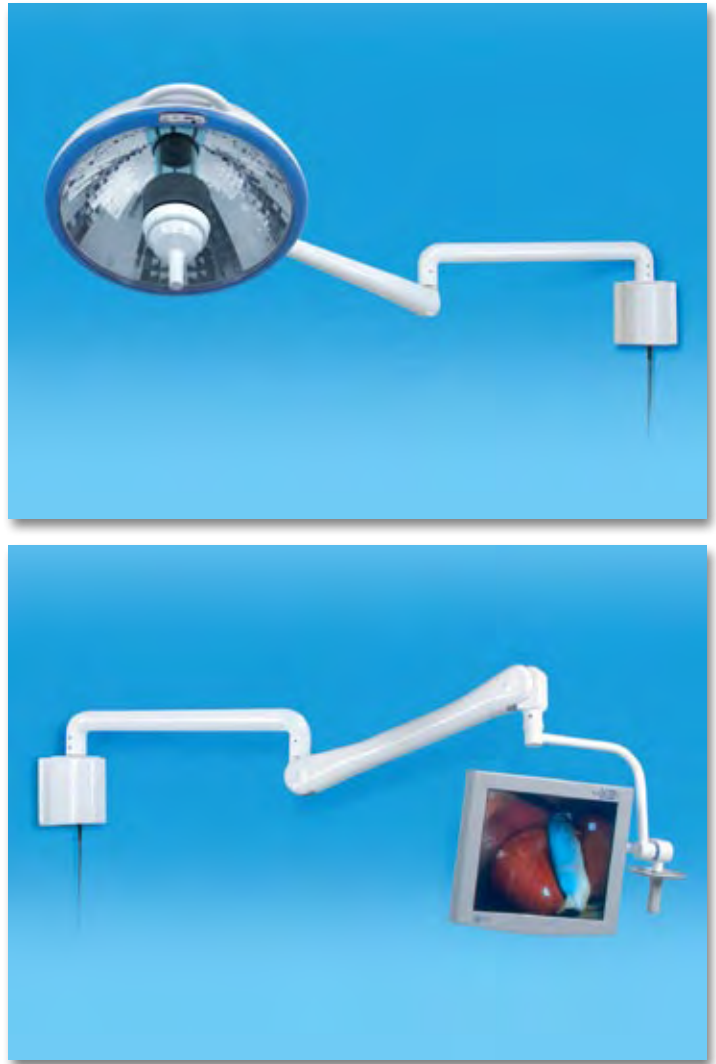

The Wall-mounted models are available for the **MH** (H.I.D.) Surgery Light or the Video Monitor Arm, allowing for maximum flexibility, where wall mounting is required.

Specifications subject to change without notice



Manufactured
in the USA